

| | | | |
|------|---------------------------|-----------|----------|
| | REVISIONS | | |
| REV. | DESCRIPTION | DATE | APPROVED |
| B | UPDATED TO MATCH 3D MODEL | 1/10/2012 | |

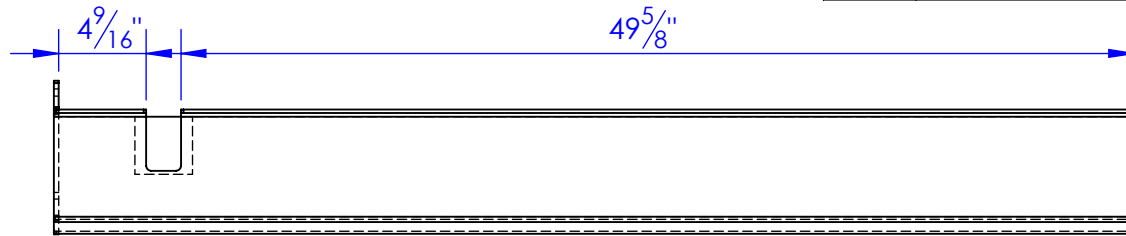

FP-FL9555-5
FENDER FLARE, DRIVER, FL9555, WLDMT
DRAWING # 90-1206
QTY: 1

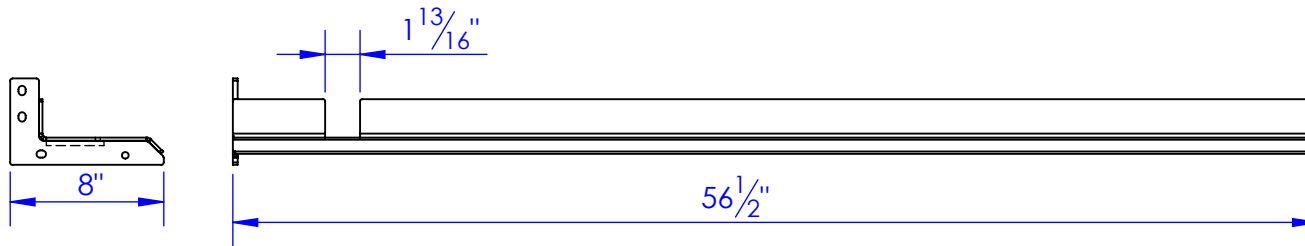
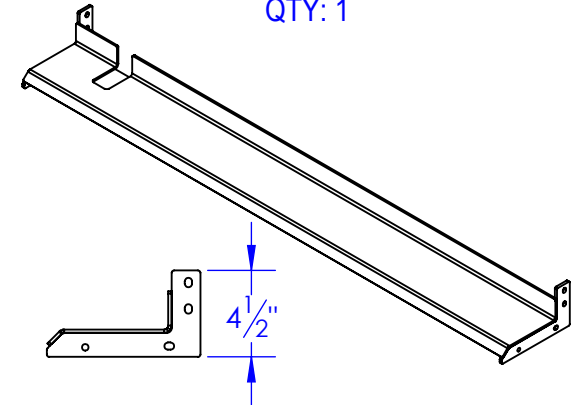

FP-FL9555-6
FENDER FLARE, PASS, FL9555, WLDMT
DRAWING # 90-1207
QTY: 1

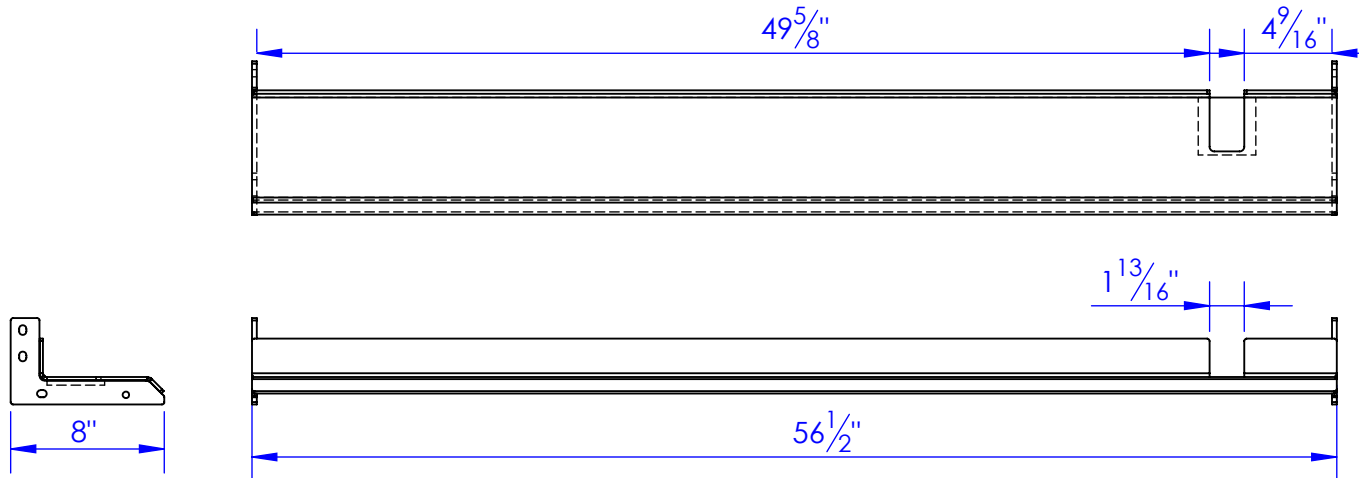
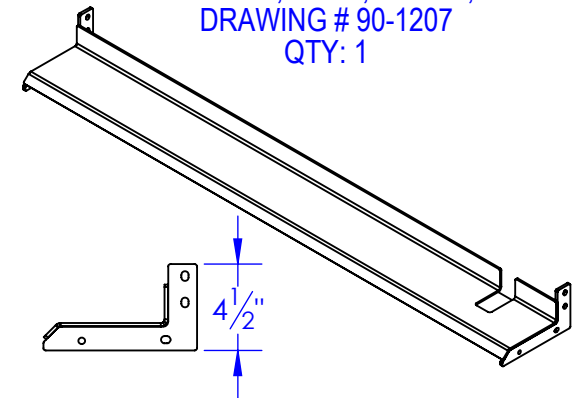

PROPRIETARY AND CONFIDENTIAL
THE INFORMATION CONTAINED IN THIS
DRAWING IS THE SOLE PROPERTY OF TRIPLE
C INC. ANY REPRODUCTION IN PART OR
AS A WHOLE WITHOUT THE WRITTEN
PERMISSION OF TRIPLE C INC. IS PROHIBITED.

DIMENSIONS ARE IN INCHES
TOLERANCES:
FRACTIONAL $\pm 1/16$
ANGULAR: MACH ± 1 BEND \pm
TWO PLACE DECIMAL ± 010
THREE PLACE DECIMAL ± 005

MATERIAL --
DO NOT SCALE DRAWING

NAME DATE
DRAWN HEATH 1/10/2012
PART #
ASM # OP-FL-9555
COMMENTS:

FENDER FLARE
FL9555, ASSY.

P.O. BOX 248,
SABETHA, KS 66534

TRIPLE C
INC.

SIZE DWG. NO. REV.
A 90-0205 B B
SCALE: 1:10 WEIGHT: -- SHEET 1 OF 1